

Katalogový list

platný od: 1/1/22

+GF+



Elektrokoleno 90°

- PE 100 SDR 11 (ISO S5)
 - 10 bar plyn / 16 bar voda
 - 4mm svařovací konektory
 - Kontrolní výronek s ochranou proti vytečení taveniny
 - Integrovaný držák - šroubky do d 63 mm
- * Dvě oddělené svařovací zóny

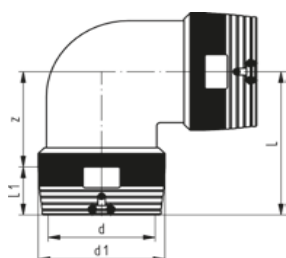
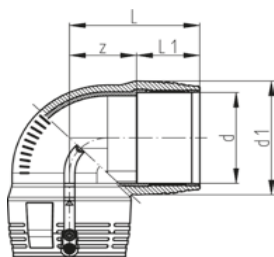
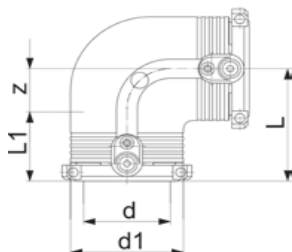

| d (mm) | obj. číslo | hmotn. (kg) | d1 (mm) | L (mm) | L1 (mm) | z (mm) | SDR trubky | |
|-----------|-------------|----------------|------------|-----------|------------|-----------|------------|-------|
| 20 | 753 101 606 | 0.080 | 35 | 54 | 34 | 20 | 9-11 | |
| 25 | 753 101 607 | 0.074 | 35 | 54 | 34 | 20 | 9-11 | |
| 32 | 753 101 608 | 0.094 | 44 | 53 | 36 | 17 | 9-11 | |
| 40 | 753 101 609 | 0.128 | 54 | 62 | 39 | 23 | 9-11 | |
| 50 | 753 101 610 | 0.196 | 66 | 71 | 43 | 28 | 9-11 | |
| 63 | 753 101 611 | 0.312 | 81 | 81 | 48 | 32 | 9-17.6 | |
| 75 | 753 101 612 | 0.415 | 97 | 94 | 54 | 40 | 9-11 | |
| 90 | 753 101 813 | 0.828 | 115 | 122 | 62 | 60 | 9-17.6 | |
| 110 | 753 101 814 | 1.224 | 140 | 147 | 72 | 76 | 9-17.6 | |
| 125 | 753 101 815 | 1.742 | 160 | 155 | 77 | 68 | 9-17.6 | |
| 140 | 753 101 816 | 2.762 | 185 | 170 | 83 | 87 | 9-17.6 | |
| 160 | 753 101 817 | 3.830 | 196 | 191 | 92 | 103 | 11-17.6 | |
| 180 | 753 101 818 | 5.410 | 219 | 210 | 96 | 114 | 11-17.6 | |
| * | 200 | 753 101 819 | 9.320 | 250 | 298 | 104 | 194 | 11-26 |
| * | 225 | 753 101 820 | 13.220 | 280 | 318 | 112 | 206 | 11-26 |
| * | 250 | 753 101 821 | 16.600 | 310 | 347 | 123 | 224 | 11-26 |

Technické údaje jsou nezávazné. Konstrukční a rozměrové změny vyhrazeny.
Platí naše všeobecné obchodní podmínky.